



Ramset® I-F

Insulation Fastening System

NEW! T4 I-F COMPACT

Insulation Fastening Innovation In A Smaller, Lighter,
More Powerful Design.



Feel the Difference

- Smaller/Lighter to Reduce Fatigue
- Increased Power for Improved Stick Rate
- 180° Rotating Scaffold/Belt Hook

ramset.com

Ramset® T4 I-F COMPACT

Ramset T4 I-F Compact Insulation Fastening System...



Installs in seconds

- Up to 4x faster than stick pins
- One-step installation
- Eliminates all fastener-related pre/post work



Reduces injuries

- Fewer hand injuries from sharp stick pins
- Less recoil than powder tools
- Lower torque than screw installations



Meets rigorous industry standards

- First to market and third-party-tested/approved
- Recommended by multiple insulation manufacturers



Reduces thermal bridging

- Integrated cap creates thermal break
- Saves energy – reduces building heating and cooling costs
- Up to 27x more efficient than other methods



Performs in multiple environments

- Works with insulation up to 6 inches thick
- Attaches directly to concrete, block, steel stud, and wood
- Works in all weather conditions

Ramset I-F will fasten into:



Mineral Wool



Extruded Polystyrene (XPS)



Expanded Polystyrene (EPS)

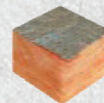

Fiberglass

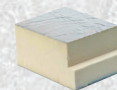

Polyisocyanurate

Concrete or Block

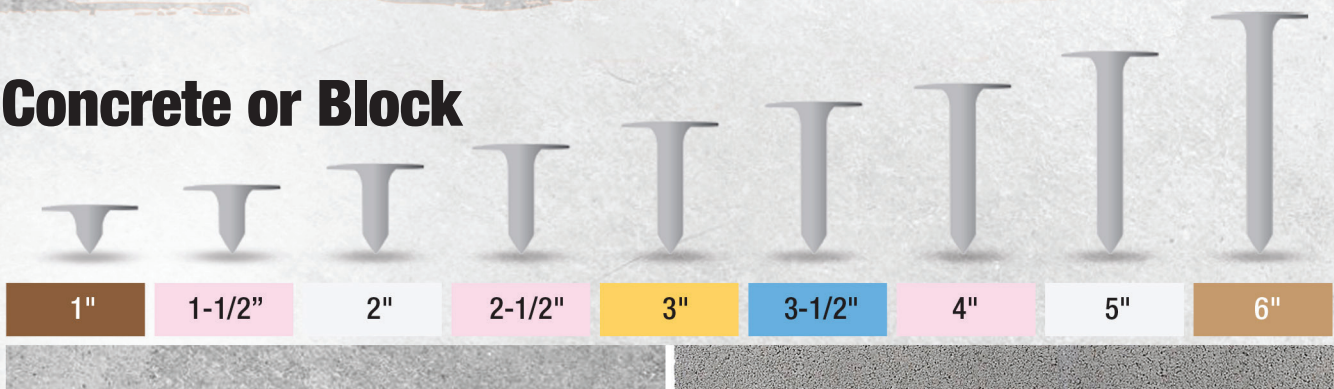

Steel Stud or Wood

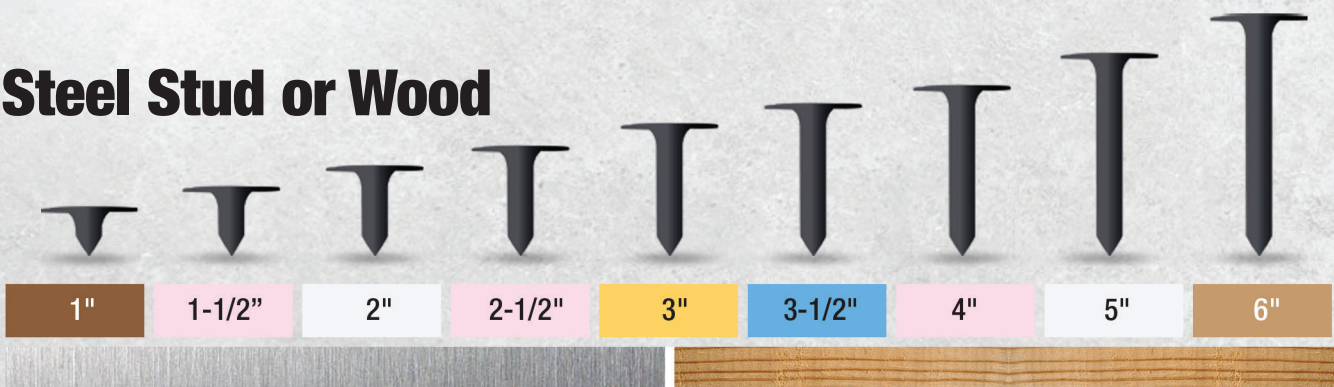

Depth adjuster
Get optimal pin performance by adjusting the setting based on type of base material.

Smaller and Lighter More Powerful

- Larger gauges for battery and gas
- Operating temperature: 5°F to 122°F
- Light-weight: only 7.3 lbs
- Battery capacity: up to 10,000 shots

Auto shut-on/off
Won't drain the Li-Ion battery when not in use

Fuel and battery gauges
No interruptions in your day because you always know your tools status

Scaffold/belt hook
Rotating belt and scaffold hook

Fuel cell included in every box of fasteners
Never have to stop a job

Steel Stud or Wood

Concrete or Block



Integrated Cap
Closed cap creates thermal break
99.5% thermally efficient when cap is closed

Washer Diam. 2-3/8"
Large bearing surface keeps insulation from sagging

Concrete or Block Pin Anatomy (IFC)

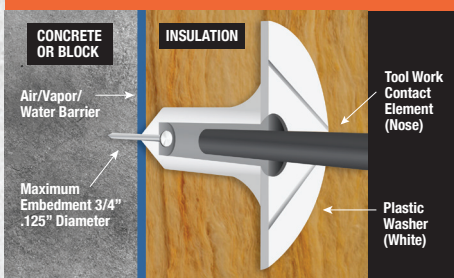

Above acoustical ceilings



Foundations and basements



Behind cladding over wood stud walls

Steel Stud or Wood Pin Anatomy (IFS)

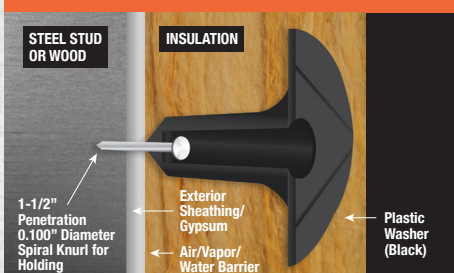

Behind cladding over concrete block walls



Interior walls on concrete block



Behind cladding over steel stud walls

Performance and Ordering Info

TOOL	PART NUMBER	PRODUCT DESCRIPTION	BOX QUANTITY
	T4IF-CT	T4 I-F Compact Tool	1

FASTENER SELECTION CHART	INSULATION THICKNESS	CONCRETE OR BLOCK PART NO.	STEEL OR WOOD PART NO.	BOX QUANTITY
	1"	T4IFC-100	T4IFS-100	500
	1-1/2"	T4IFC-112	T4IFS-112	500
	2"	T4IFC-200	T4IFS-200	500
	2-1/2"	T4IFC-212	T4IFS-212	500
	3"	T4IFC-300	T4IFS-300	500
	3-1/2"	T4IFC-312	T4IFS-312	500
	4"	T4IFC-400	T4IFS-400	500
	5"	T4IFC-500	T4IFS-500	500
6"	T4IFC-600	T4IFS-600	400	

Add this specification to the project...

Specification: CSI Division07- Thermal and moisture protection insulation shall be mechanically fastened to the building substrate or component with Ramset I-F Thermal-Break insulation fasteners from ITW Ramset, Glenview, IL.

CONCRETE	PART NUMBER SERIES	SHANK DIAMETER (INCH)	CONCRETE STRENGTH (PSI)	ALLOWABLE/ULTIMATE TENSION LOADS (lbf)
	IFC	0.125	3600 -6500	35 - 211

HOLLOW CONCRETE BLOCK	PART NUMBER SERIES	SHANK DIAMETER (INCH)	ALLOWABLE/ULTIMATE TENSION LOADS (lbf)
	IFC	0.125	35 - 184

STEEL STUDS	PART NUMBER SERIES	SHANK DIAMETER (INCH)	INSTALLED IN COLD FORMED STEEL FRAMING (lbf)				
			22 Gage	20 Gage	18 Gage	16 Gage	14 Gage
	IFS (Knurled)	0.100	20 - 120	33 - 200	46 - 280	60 - 360	62 - 371

WOOD	PART NUMBER SERIES	SHANK DIAMETER (INCH)	INSTALLED IN 15/32" (1/2" NOMINAL) 4 PLY PLYWOOD SHEATHING (lbf)
	IFS (Knurled)	0.100	16 - 93

		INSULATION THICKNESS					
		1 in	2 in	3 in	4 in	5 in	6 in
Reference	U – Factor (W/m ² °C)	1.1786	0.7122	0.5103	0.3976	0.3257	0.2758
	Efficiency (%)	100.00%	100.00%	100.00%	100.00%	100.00%	100.00%
Stick Pin	U – Factor (W/m ² °C)	1.2422	0.7706	0.5597	0.4397	0.3621	0.3078
	Efficiency (%)	94.88%	92.42%	91.17%	90.43%	89.94%	89.59%
Ramset I-F	U – Factor (W/m ² °C)	1.1845	0.7162	0.5132	0.3999	0.3276	0.2773
	Efficiency (%)	99.50%	99.45%	99.44%	99.43%	99.42%	99.42%



Tool Repair

Please visit www.ramsetrepair.com or call 800-222-6990.



155 Harlem Ave • Glenview, IL 60025
Phone: 800-848-5611 • www.ramset.com

Evaluations:

ICC-ESR-1955
ASTM E331 (Water Penetration)
ASTM E2178 (Air Leakage)
ASTM E84 (Surface Burning)

Fastener Specifications:

- Pin Material: Heat treated carbon steel
- Pin Finish: Mechanical Zinc Plated
- Washer Dia: 2-3/8"
- Pin Dia: Concrete 0.125" / Steel 0.100"
- 2-3/8" Holding Diameter
- The fastener assembly is clearly branded Ramset along with the length of the fastener assembly