

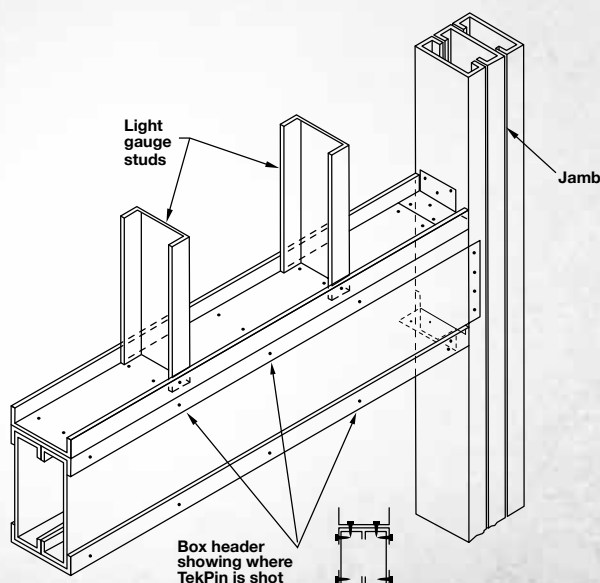

TEK034 Pins Revolutionize Metal-to-Metal Fastening

For commercial framing contractors who assemble and install on-site or pre-fabricate box headers or jamb studs, our TEK034 collated knurled pin installs flush into 14, 16 and 18-gauge steel five times faster than self-drilling screws.



Advantages

- 5x Faster than self-drilling screws
- Reduced operator fatigue
- Head drives flat for flush finish

**Install using the
Ramset TrakFast TF1200 Tool**

- Breakaway collation for a flush finish
- Ramset-engineered knurl provides excellent withdrawal and shear loads



- Head drives flat
- Knurl extends to base of head
- 3/4" Knurled Pin





Fastening System Productivity

- Up to five times faster than Tek screws
- Estimate box header installation time in minutes – not hours
- Flush finish

APPLICATIONS



Stud Wall



Box Headers



Fastening Steel Frames



Light Gauge Steel Framing



Sheet Metal to Framing

MOST COMMON FASTENERS

PART #	PIN LENGTH		BOX QUANTITY
	IN.	(MM)	
TEK034	3/4"	19mm	1000/per inner carton w/ fuel cell and 5000 per master carton

THICKNESS ATTACHMENTS

14G, 16G, 18G, and 20G when attaching to 14G-18G

► ramset.com